

58 00 BRISTOL PKWY

CULVER CITY CALIFORNIA

>>> 33,514 SF
AVAILABLE FOR SUBLEASE



NEWMARK

RYAN HARDING

Executive Managing Director
t 213-596-2044
ryan.harding@nrmk.com
CA RE Lic. #01737669

JENNIFER FRISK

Senior Managing Director
t 213-596-2261
jennifer.frisk@nrmk.com
CA RE Lic. #01880015

Building Highlights



Highly creative full-floor office sublease at Culver City's C3



Floor-to-ceiling windows offer excellent views and natural light



Full building length balconies create operable indoor/outdoor space



Private building access via dedicated sky bridges from parking garage



Onsite food and fitness amenities plus multiple outdoor common areas

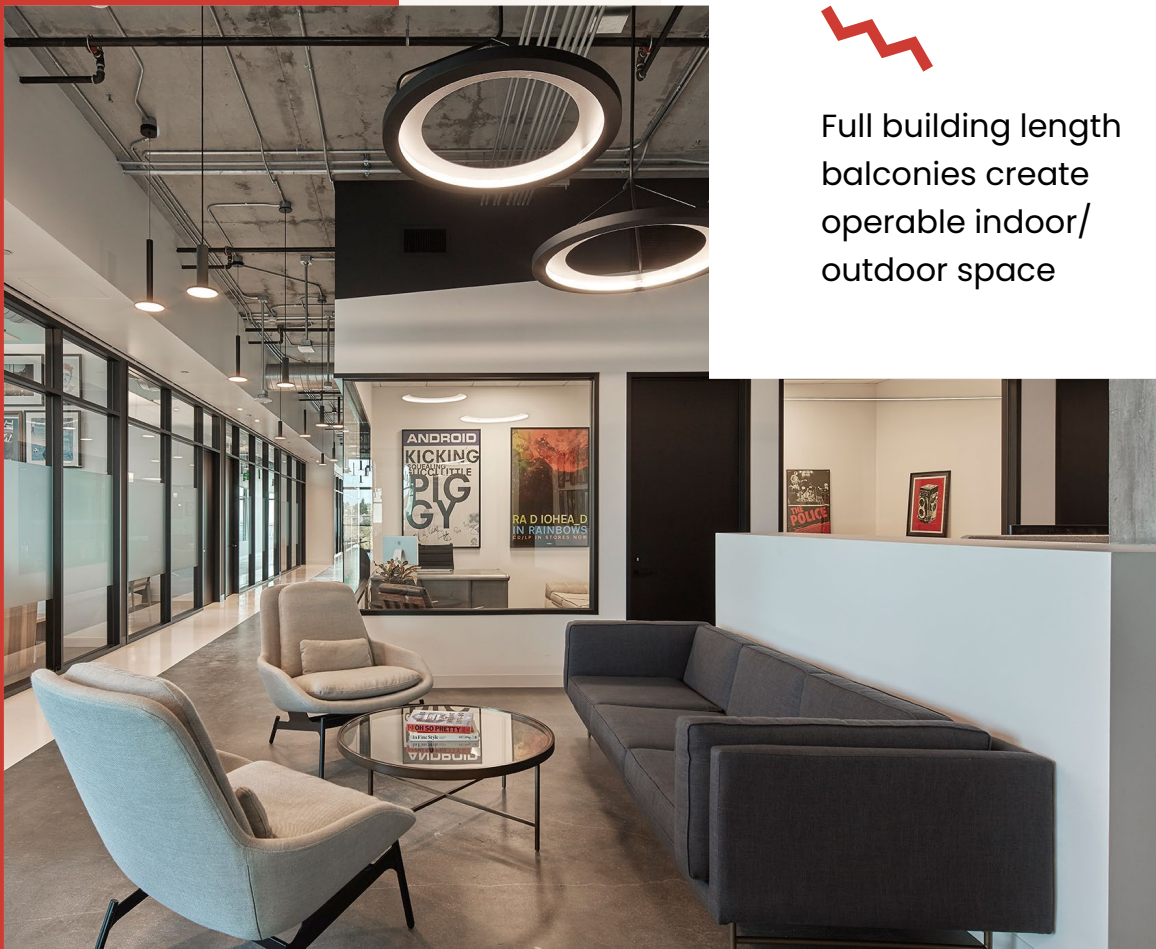

Terms

5800 Bristol Parkway
Culver City, CA 90230
ADDRESS

33,514 SF
PREMISES

Thru October 2028
TERM

60 Days
AVAILABLE

Withheld
ASKING RATE

3.18/1,000 SF
PARKING



Floor Plan

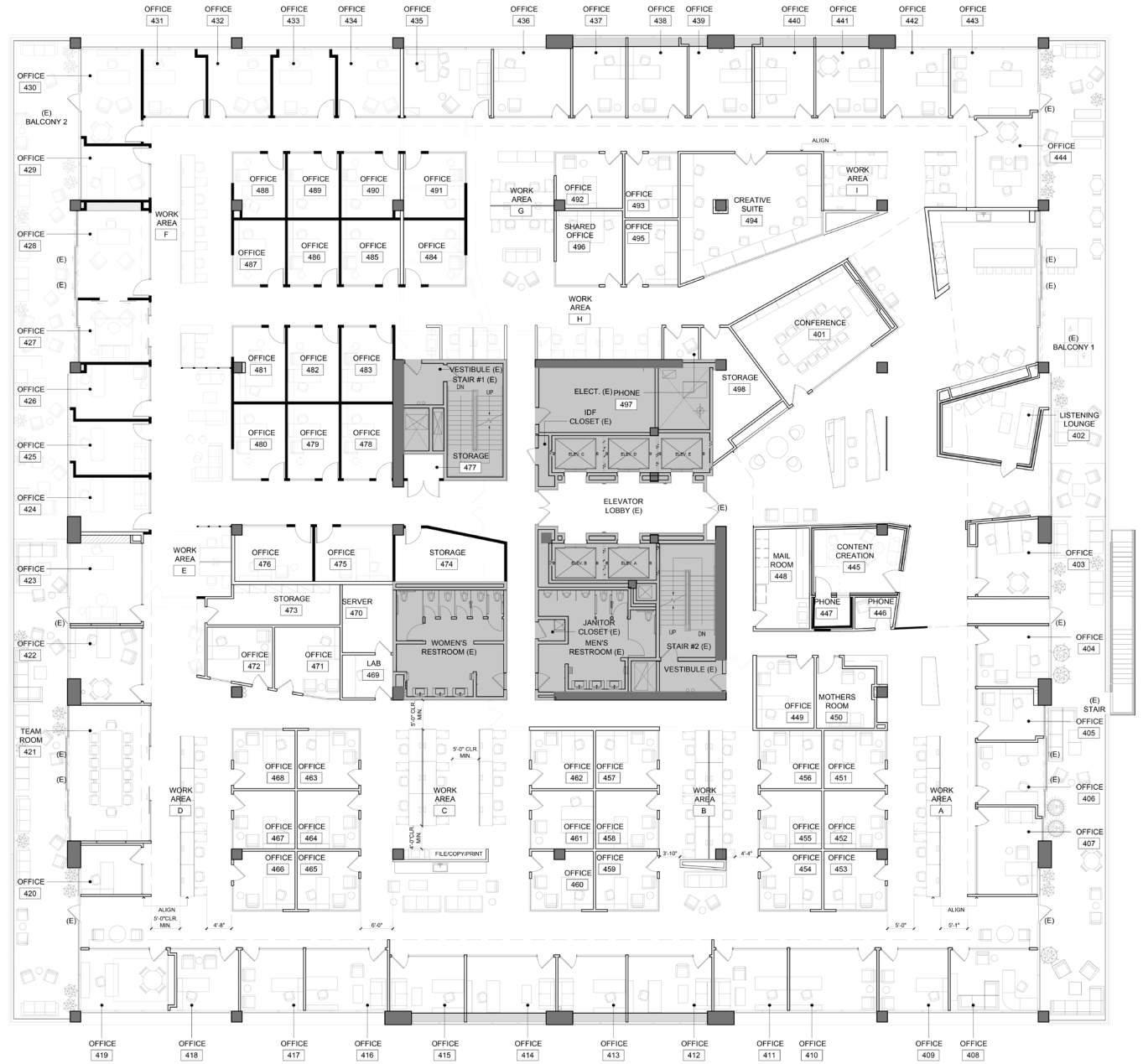



58 00 BRISTOL PKWY

CULVER CITY CALIFORNIA

RYAN HARDING

Executive Managing Director
t 213-596-2044
ryan.harding@nmrk.com
CA RE Lic. #01737669

JENNIFER FRISK

Senior Managing Director
t 213-596-2261
jennifer.frisk@nmrk.com
CA RE Lic. #01880015

NEWMARK

Corporate License #01355491

The information contained herein has been obtained from sources deemed reliable but has not been verified and no guarantee, warranty or representation, either express or implied, is made with respect to such information. Terms of sale or lease and availability are subject to change or withdrawal without notice.